

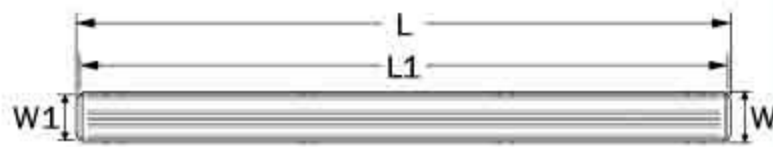

WEATHER PROOF FITTING



Weather Proof Fitting installed with Wireguard



Plan View

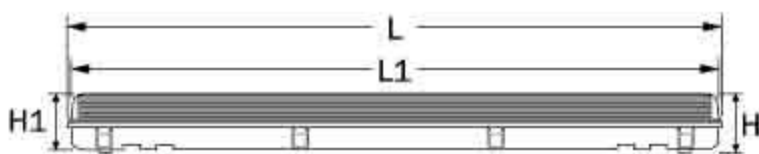

Front View

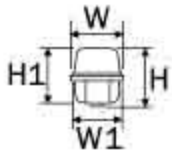

SINGLE

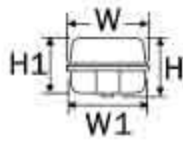

TWIN

Side View

Features:

- Ideal for use in excessive dusty humidity and corrosive environment.
- Made from extreme durable high impact injection moulded and heat resistant polystyrene.
- Provide IP 65 degree of protection.
- Easy installation with superior speed mounting system without using any specialize tool.
- Strong sheet steel component plate that is stove enameled inside and outside.
- Fitting can be supplied with emergency power pack (PP), electronic ballast (EB) or extra low loss magnetic ballast (6WLL).



Emergency Power Pack

Special features of optional closure

- **Wireguard** - Wireguard can be added to prevent vandalism and breakage, hence less maintenance.

Application:

- Chemical factories
- Parking areas
- Swimming pool areas
- Food processing factories
- Loading bays
- Beach



Stainless steel clip

MODEL	LAMPS TYPE & RATING	DIMENSION						UNCORRECTED POWER FACTOR
		L	L1	H	H1	W	W1	
PCO 120 AC/6WLL	T8 1 X 18W	668	654	112	105	100	98	0.29
PCO 140 AC/6WLL	T8 1 X 36W	1266	1254	112	105	100	98	0.40
PCO 220 AC/6WLL	T8 2 X 18W	668	654	112	105	158	156	0.27
PCO 240 AC/6WLL	T8 2 X 36W	1266	1254	112	105	158	156	0.43
PCO 158 AC/6WLL	T8 1 X 58W	1565	1554	112	105	100	98	0.52
PCO 120 AC/114/EB	T5 1 X 14W	668	654	112	105	100	98	
PCO 140 AC/128/EB	T5 1 X 28W	1226	1254	112	105	100	98	
PCO 220 AC/214/EB	T5 2 X 14W	668	654	112	105	158	156	
PCO 240 AC/228/EB	T5 2 X 28W	1226	1254	112	105	158	156	
PCO 158 AC/149/EB	T8 1 X 49W	1565	1554	112	105	100	98	